

N36°59'29"E  
42.67  
WATER'S EDGE

158.32  
BLOCK 5.

N36°5'00"E  
68.91  
WATER'S EDGE  
(P3&SET)

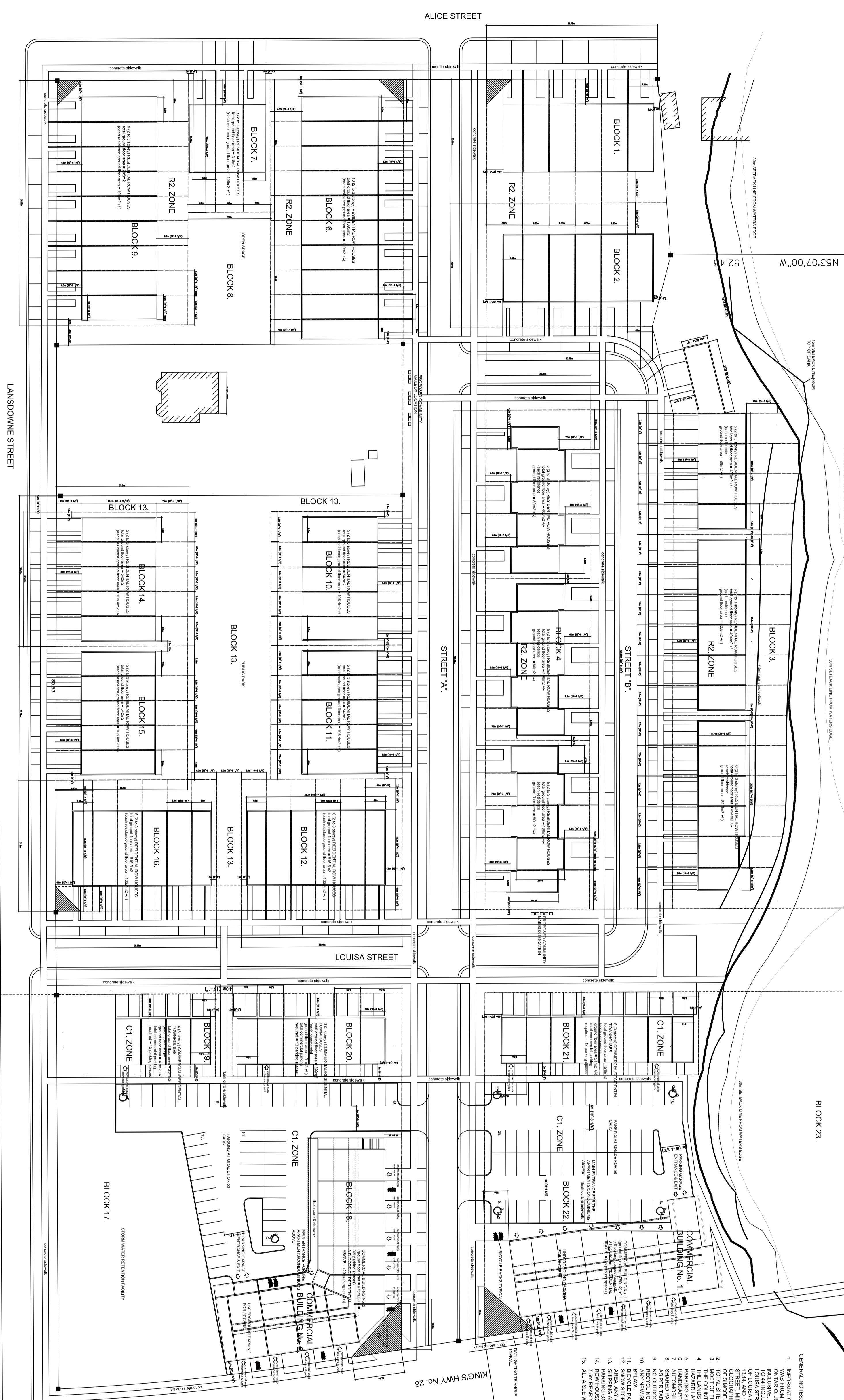

- GENERAL NOTES:**
1. INFORMATION USED OR ACQUIRED IN THE DEVELOPMENT OF THIS SITE PLAN WAS FROM RUDY WAK SINTERING LTD. (ONTARIO LAND SURVEYOR) SHARE INCLOSURE 46 & 47 SOUTHWEST SIDE OF ARTHUR STREET AND ALL OF LOTS 40 LOUISA STREET AND ALL OF PLOT LOTS 1 TO 14 INCLUSIVE SOUTHWEST SIDE OF LOUISA STREET AND PART OF PLOT LOTS 1 AND 2, AND ALL OF PLOT LOTS STREET 1, MOUNTAIN STREET, AND ALBERT STREET, TOWN OF THORNBERY, OF SIMCOE/TOWN OF THORNBERY, TOWN OF THE BLUE MOUNTAINS COUNTY OF SIMCOE/TOWN OF THORNBERY, TOWN OF THE BLUE MOUNTAINS COUNTY.
  2. TOTAL SITE AREA IS 66.86 HECTARES (164.8 ACRES).
  3. THE COUNTY OFFICIAL PLAN, WITH A PORTION DESIGNATED AS HAZARDOUS LAND.
  4. THE LANDS ARE DESIGNATED COMMERCIAL AREA, COMMUNITY LIVING AREA AND COMMERCIAL RESIDENTIAL AREA.
  5. PARKING STALL SIZES SHOWN ARE 2.5m WIDE X 5.5m LONG.
  6. DRIVEWAY SIZES SHOWN ARE 3.0m WIDE X 5.5m LONG.
  7. AVAILABILITY FOR USE IS SUBJECT TO THE COUNTY OFFICIAL PLAN.
  8. SHARED PARKING FOR THE COMMERCIAL BUILDINGS AND APARTMENTS ABOVE AND OUTDOOR GARAGE OR RECYCLING PROPOSED ALL GARAGE AND
  9. ANY NEW GARAGE IS SUBJECT TO THE TOWN OF THE BLUE MOUNTAINS SIGN BY-LAW.
  10. PARKING IS SHOWN NEAR THE COMMERCIAL, BLUE DRIVE.
  11. SNOW STORAGE TO BE STORED ON SITE IN THE DESIGNATED SNOW STORAGE AREA AND REMOVED FROM SITE OF COMMERCIAL BLOCKS 1 AND 2 TO BE IN THE DESIGNATED SNOW STORAGE AREA.
  12. PARKING GARAGE, 4.6m WIDE LOT FRONTAGE, 6.8m FRONT YARD SET BACK.
  13. 7.5m REAR YARD SET BACK.
  14. ALL ASSESSMENTS WITHIN THE PARKING LOTS ARE 6.0m.
  15. ALL ASSESSMENTS WITHIN THE PARKING LOTS ARE 6.0m.

**SITE STATISTICS (TOTAL SITE AREA = 6.6 HECTARES)**

LAND USE	NUMBER OF UNITS	GROUND FLOOR AREA	PARKING PROVIDED
RESIDENTIAL, TOWNHOUSES	54 UNITS	5691 m <sup>2</sup>	2 spaces per unit
RESIDENTIAL, APARTMENTS	54 UNITS	1117 m <sup>2</sup>	1 space per unit
COMMERCIAL, RESIDENTIAL	2 UNITS	1750 m <sup>2</sup>	2 spaces per unit
COMMERCIAL, BUSINESS	2 UNITS	1750 m <sup>2</sup>	2 spaces per unit
COMMERCIAL, OFFICE	2 UNITS	1750 m <sup>2</sup>	2 spaces per unit
COMMERCIAL, RETAIL	2 UNITS	1750 m <sup>2</sup>	2 spaces per unit
COMMERCIAL, INDUSTRIAL	2 UNITS	1750 m <sup>2</sup>	2 spaces per unit
COMMERCIAL, STORAGE	2 UNITS	1750 m <sup>2</sup>	2 spaces per unit
COMMERCIAL, OTHER	2 UNITS	1750 m <sup>2</sup>	2 spaces per unit
<b>TOTAL</b>	<b>118 UNITS</b>	<b>17500 m<sup>2</sup></b>	<b>118 spaces</b>

**SCHEDULE OF LAND USE**

PROPOSED LAND USE	BLOCKS	YIELD UNITS/BLOCKS	AREA
RESIDENTIAL, TOWNHOUSES	1, 2, 3, 4, 5, 6, 7, 8, 9, 10, 11, 12, 13, 14, 15	96 UNITS/18 BLOCKS	4.1 HECTARES
RESIDENTIAL, APARTMENTS	16, 17, 18, 19, 20, 21	108 UNITS/6 BLOCKS	2.7 HECTARES
COMMERCIAL, BUSINESS	14, 18, 22	14 UNITS/3 BLOCKS	27 HECTARES
COMMERCIAL, OFFICE	15, 16, 17, 18, 19, 20, 21	77 UNITS/6 BLOCKS	1.7 HECTARES
COMMERCIAL, RETAIL	15, 16, 17, 18, 19, 20, 21	77 UNITS/6 BLOCKS	1.7 HECTARES
COMMERCIAL, INDUSTRIAL	15, 16, 17, 18, 19, 20, 21	77 UNITS/6 BLOCKS	1.7 HECTARES
COMMERCIAL, STORAGE	15, 16, 17, 18, 19, 20, 21	77 UNITS/6 BLOCKS	1.7 HECTARES
COMMERCIAL, OTHER	15, 16, 17, 18, 19, 20, 21	77 UNITS/6 BLOCKS	1.7 HECTARES
<b>TOTAL</b>		<b>348 UNITS/24 BLOCKS</b>	<b>17.6 HECTARES</b>

**ASSOCIATION OF ARCHITECTS**  
ONTARIO

Project title: LANSOWNE & ALICE STREET DEVELOPMENT  
Township: THORNBERY  
Town: TOWN OF THE BLUE MOUNTAINS  
Ontario

Project number: 2021-1-1000  
Drawn by: [Name]  
Checked by: [Name]  
Scale: 1:1000  
Sheet title: SITE LAYOUT (NOTES) Drawing no.: A1.0

**Revisions to drawing**

Revised	By	Date	Description
1	[Name]	22/09/24	ADD & REVISE DIMENSIONS
2	[Name]	22/09/24	ADD DIMENSIONS
3	[Name]	22/09/24	REVISED LOT LINES
4	[Name]	22/09/24	REVISED LOT LINES
5	[Name]	22/09/24	REVISED LOT LINES
6	[Name]	22/09/24	REVISED LOT LINES
7	[Name]	22/09/24	REVISED LOT LINES
8	[Name]	22/09/24	REVISED LOT LINES
9	[Name]	22/09/24	REVISED LOT LINES
10	[Name]	22/09/24	REVISED LOT LINES
11	[Name]	22/09/24	REVISED LOT LINES
12	[Name]	22/09/24	REVISED LOT LINES
13	[Name]	22/09/24	REVISED LOT LINES
14	[Name]	22/09/24	REVISED LOT LINES
15	[Name]	22/09/24	REVISED LOT LINES
16	[Name]	22/09/24	REVISED LOT LINES
17	[Name]	22/09/24	REVISED LOT LINES
18	[Name]	22/09/24	REVISED LOT LINES
19	[Name]	22/09/24	REVISED LOT LINES
20	[Name]	22/09/24	REVISED LOT LINES
21	[Name]	22/09/24	REVISED LOT LINES
22	[Name]	22/09/24	REVISED LOT LINES
23	[Name]	22/09/24	REVISED LOT LINES
24	[Name]	22/09/24	REVISED LOT LINES
25	[Name]	22/09/24	REVISED LOT LINES
26	[Name]	22/09/24	REVISED LOT LINES
27	[Name]	22/09/24	REVISED LOT LINES
28	[Name]	22/09/24	REVISED LOT LINES
29	[Name]	22/09/24	REVISED LOT LINES
30	[Name]	22/09/24	REVISED LOT LINES
31	[Name]	22/09/24	REVISED LOT LINES
32	[Name]	22/09/24	REVISED LOT LINES
33	[Name]	22/09/24	REVISED LOT LINES
34	[Name]	22/09/24	REVISED LOT LINES
35	[Name]	22/09/24	REVISED LOT LINES
36	[Name]	22/09/24	REVISED LOT LINES
37	[Name]	22/09/24	REVISED LOT LINES
38	[Name]	22/09/24	REVISED LOT LINES
39	[Name]	22/09/24	REVISED LOT LINES
40	[Name]	22/09/24	REVISED LOT LINES
41	[Name]	22/09/24	REVISED LOT LINES
42	[Name]	22/09/24	REVISED LOT LINES
43	[Name]	22/09/24	REVISED LOT LINES
44	[Name]	22/09/24	REVISED LOT LINES
45	[Name]	22/09/24	REVISED LOT LINES
46	[Name]	22/09/24	REVISED LOT LINES
47	[Name]	22/09/24	REVISED LOT LINES
48	[Name]	22/09/24	REVISED LOT LINES
49	[Name]	22/09/24	REVISED LOT LINES
50	[Name]	22/09/24	REVISED LOT LINES

**Blue Meadows**

383 MANAB STREET UNIT 124  
SOUTHAMPTON ONTARIO  
NOH 21.0  
TEL : 1-888-397-4598  
FAX : 1-519-389-4466  
CELL : 1-519-389-4466  
email : montgomery.king@sympatico.ca

**DRAWINGS ARE NOT TO BE SCALED**

Copyright © 2021 Blue Meadows. All rights reserved. No part of this drawing may be reproduced, stored in a retrieval system, or transmitted in any form or by any means, electronic, mechanical, photocopying, recording, or by any information storage and retrieval system, without the prior written permission of Blue Meadows.

**ISSUED FOR REVIEW**

**ISSUED FOR TENDER**

**ISSUED FOR PERMIT**

**ISSUED FOR CONSTRUCTION**

**Blue Meadows**

**MONTGOMERY PHILIP KING ARCHITECT INC.**

**383 MANAB STREET UNIT 124 SOUTHAMPTON ONTARIO NOH 21.0**

**TEL : 1-888-397-4598 FAX : 1-519-389-4466 CELL : 1-519-389-4466 email : montgomery.king@sympatico.ca**

**DRAWINGS ARE NOT TO BE SCALED**

**Copyright © 2021 Blue Meadows. All rights reserved. No part of this drawing may be reproduced, stored in a retrieval system, or transmitted in any form or by any means, electronic, mechanical, photocopying, recording, or by any information storage and retrieval system, without the prior written permission of Blue Meadows.**

**ISSUED FOR REVIEW**

**ISSUED FOR TENDER**

**ISSUED FOR PERMIT**

**ISSUED FOR CONSTRUCTION**

**Blue Meadows**

**MONTGOMERY PHILIP KING ARCHITECT INC.**

**383 MANAB STREET UNIT 124 SOUTHAMPTON ONTARIO NOH 21.0**

**TEL : 1-888-397-4598 FAX : 1-519-389-4466 CELL : 1-519-389-4466 email : montgomery.king@sympatico.ca**

**DRAWINGS ARE NOT TO BE SCALED**

**Copyright © 2021 Blue Meadows. All rights reserved. No part of this drawing may be reproduced, stored in a retrieval system, or transmitted in any form or by any means, electronic, mechanical, photocopying, recording, or by any information storage and retrieval system, without the prior written permission of Blue Meadows.**